

INSTALLATION INSTRUCTIONS

Model: **CB3442, 44, 62, 64, 72, 74**
Fixture Family: **LED QTR-SPHERE**
Document Description: Installation Instructions for
CARLTON/OLYMPIA/FAIRFAX Luminaires

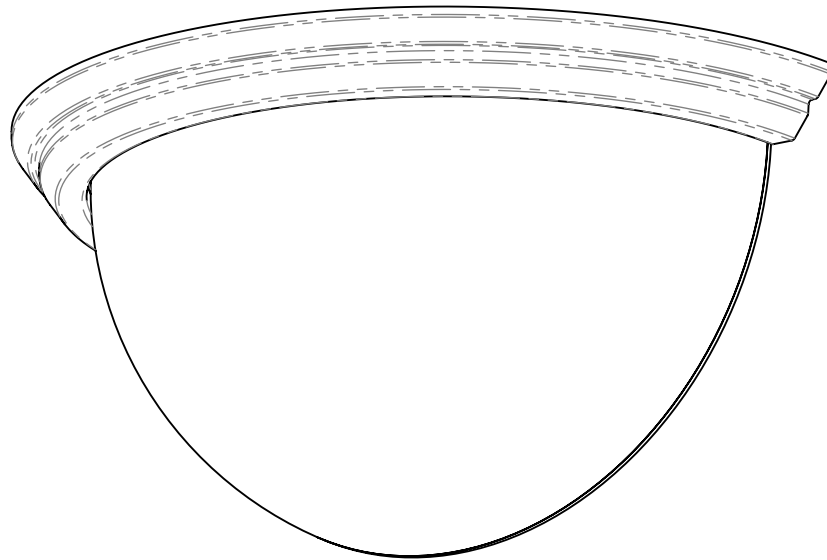

*CB3442 SHOWN

CARLTON

CB3442
CB3444

OLYMPIA

CB3462
CB3464

FAIRFAX

CB3472
CB3474



When using electrical equipment, basic safety precautions should always be followed, including the following:

- Read all instructions carefully before installing and save for future use.
- Make sure all connections are in accordance with the National Electrical Code and local regulations.
- To avoid possible electric shock, be sure the power supply is turned off before servicing or installing the fixture.
- Service should be performed by qualified personnel.
- These instructions may not cover all details or variations. If additional information is needed, please contact Visa Lighting.

INSTALLATION INSTRUCTIONS

Model: **CB3442, 44, 62, 64, 72, 74**
Fixture Family: **LED QTR-SPHERE**
Document Description: Installation Instructions for
CARLTON/OLYMPIA/FAIRFAX Luminaires

VISA LIGHTING
AN OLDENBURG GROUP COMPANY
1717 West Civic Drive Milwaukee, WI 53209
414-354-6600
Design Modification Rights Reserved
© Visa Lighting 2016

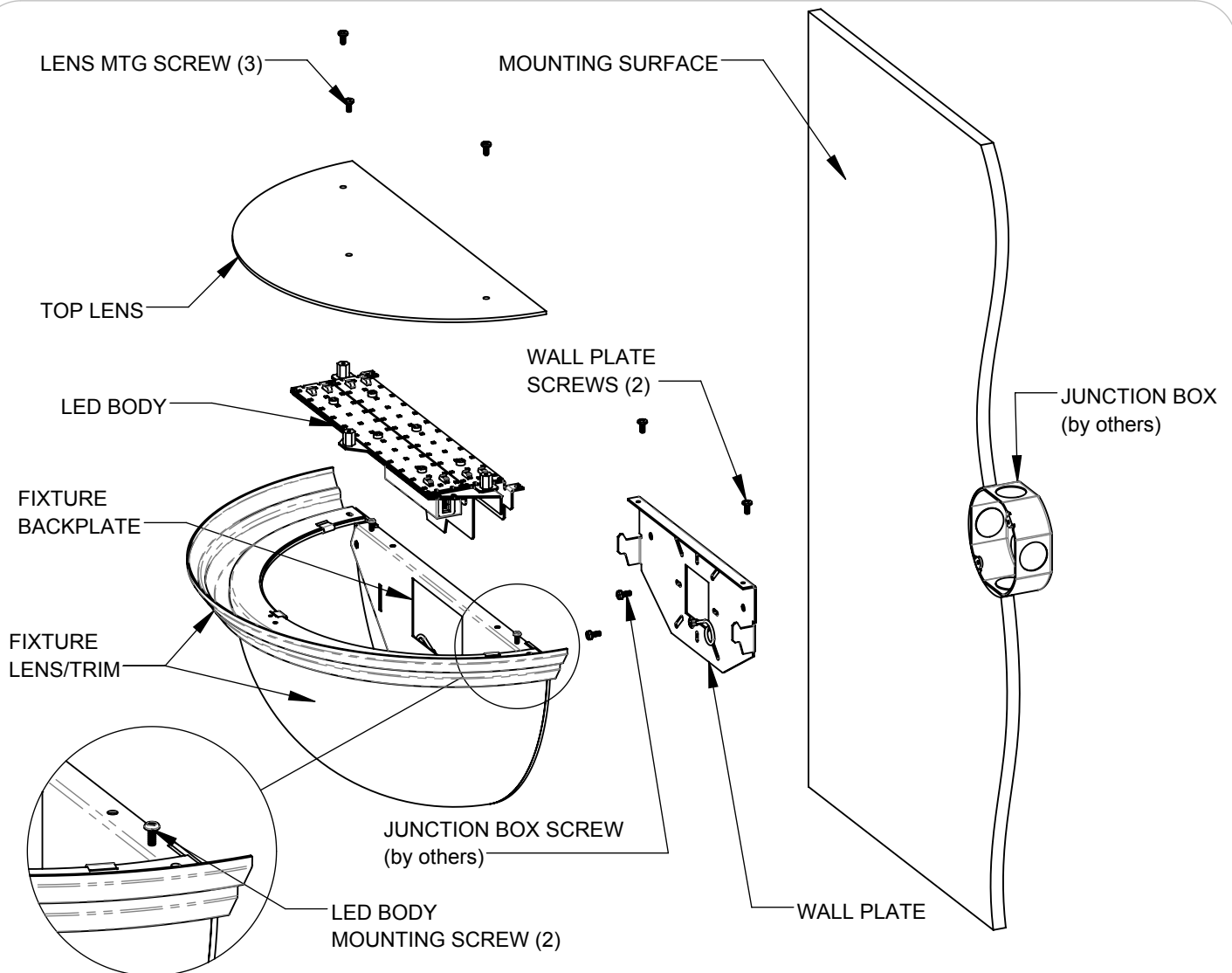

1. Remove top lens by removing (3) lens mounting screws.
2. Remove wall plate from back of fixture by temporarily removing the (2) wall plate mounting screws. (save for reattachment in step 5).
3. Remove LED body from fixture backplate by loosening LED body mounting screws. (There is no need to remove them, just loosen enough to be able to remove LED body).
4. Secure wall mounting plate to junction box with screws (by others). Feed wires through opening.
5. Secure fixture lens/trim to wall mounting plate (allowing to feed wires through opening)
6. Make all necessary wire connections to the LED body in accordance with all national and local codes.
7. Push feed wires back into junction box and secure LED body to back plate on fixture lens/trim. (Note: lower tab on LED body inserts into backplate - then secure mounting screws on top)
8. Reattach top lens to LED body.

When using electrical equipment, basic safety precautions should always be followed, including the following:

- Read all instructions carefully before installing and save for future use.
- Make sure all connections are in accordance with the National Electrical Code and local regulations.
- To avoid possible electric shock, be sure the power supply is turned off before servicing or installing the fixture.
- Service should be performed by qualified personnel.
- These instructions may not cover all details or variations. If additional information is needed, please contact Visa Lighting.

Drawing: 760889XX

Rev: A

Sheet: 2 of 2

Eng: CLD

Date Drawn: 4/24/18